

MOVINCOOL®

Pioneering New Solutions With Portable Air-Conditioning



DigelAir
HVAC SUPPLY

1-21 Grenfell Crescent
Ottawa, Ontario K2G 0G3
Phone: 613-723-0359
Fax: 613-226-4892
Toll Free: 1-888-279-2505
Email: sales@digelair.com
Web: www.digelair.com

Model: CLASSIC PLUS 14

SPECIFICATIONS:

Cooling Capacity = 13200 BTU, 440 CFM evap. fan, 880 CFM cond. fan
Operating Conditions, inlet air = min 70°F max 113°F @ 50% RH
Electrical Requirements = 115/1/60 volts, 12.3 A, requires 15 amp breaker, 5-15 plug
Unit Weight = 153 lbs. (shipping 195 lbs.)
Unit Dimensions = 19" W x 26" D x 41" Minimum room temperature set point = 70°F

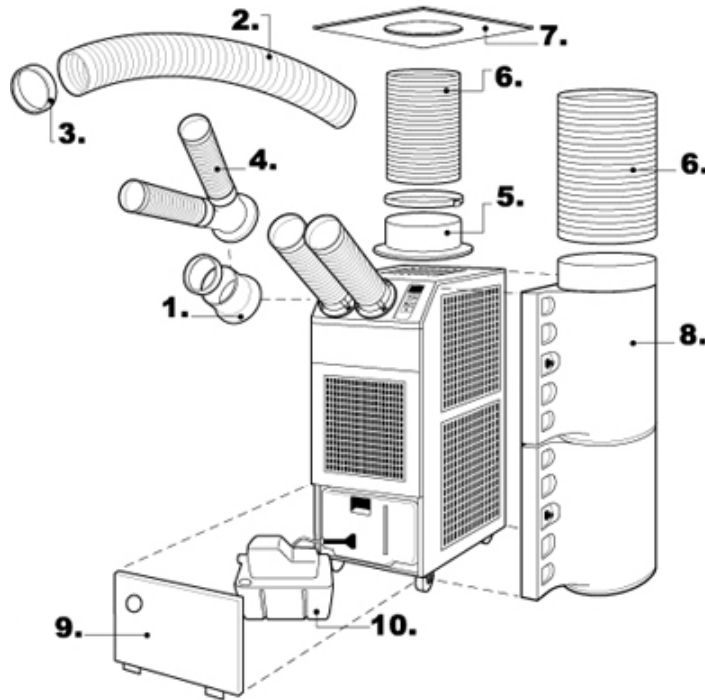

| No. | Part Name | Classic Plus 14 - Part Description | Part Number |
|-----|-------------------------|---|---------------|
| 1. | Cold Air Flange | 5" diameter white metal flange with wire clamp and mounting screws. | 481170-0180 |
| 2. | Cold Air Extension Duct | 5" diameter white plastic duct that extends from 6 1/2' to 10' in length. | 481744-0090 |
| 3. | Trim Ring | 5" diameter black plastic ring mounts as end caps for extension ducts. | 481851-0200 |
| 4. | Dual Duct | 5" diameter white plastic flange with two 4" nozzles that extend to 3 1/2' in length. | 484209-0030 |
| 5. | Warm Air Flange | 12" diameter gray metal flange with wire clamp and mounting screws. | 481170-0190 |
| 6. | Warm Air Duct | 12" adjustable diameter white plastic duct that extends from 6 1/2' to 10' in length. | 481744-0060 |
| 7. | Ceiling Tile | 24" x 24" white tile with 12" hole for warm air duct. | LA146373-8280 |
| 8. | Air Plenum | White plastic plenum, hinged for filter cleaning. | LAY84270-0020 |
| 9. | Cover Plate | Blue metal plate covers condensate collection area. | 484009-0480 |
| 10. | Condensate Pump Kit | 110V pump kit includes 3/8" diameter x 20' length hose and installation hardware. | CPK3 |